

DuROCK PUCCS EIFS

Exterior Insulation Finish System for Low Rise and Residential Construction

ARCHITECTURAL FINISHING SYSTEMS

- Wrap insulation edge with mesh-reinforced base coat
- DuROCK PUCCS EIFS
- * Soffit
- DuROCK Finish Coat

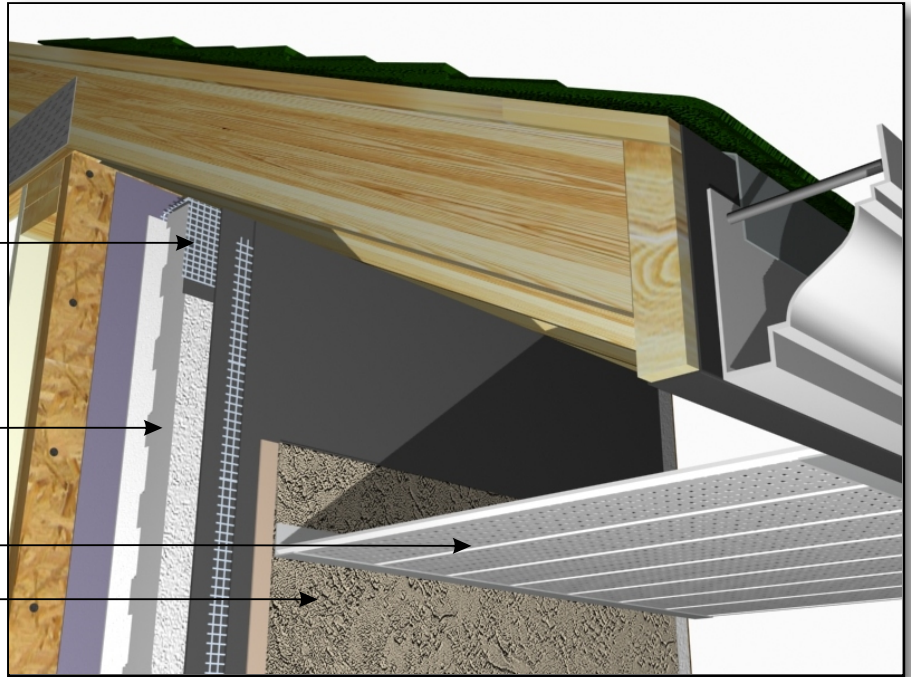

PUCCS-LRRC (10)
TERMINATION AT SOFFIT

- DuROCK PUCCS, EPS Insulation Board
- Polar Bear applied around electric box and onto sheathing
- Wrap insulation edge with reinforcing mesh, terminate base coat at GDCC
- * Weather tight electrical box
- Note: Provide approximate 15 mm space between electric box and insulation board
- * Backer Rod and Sealant

(* by others)

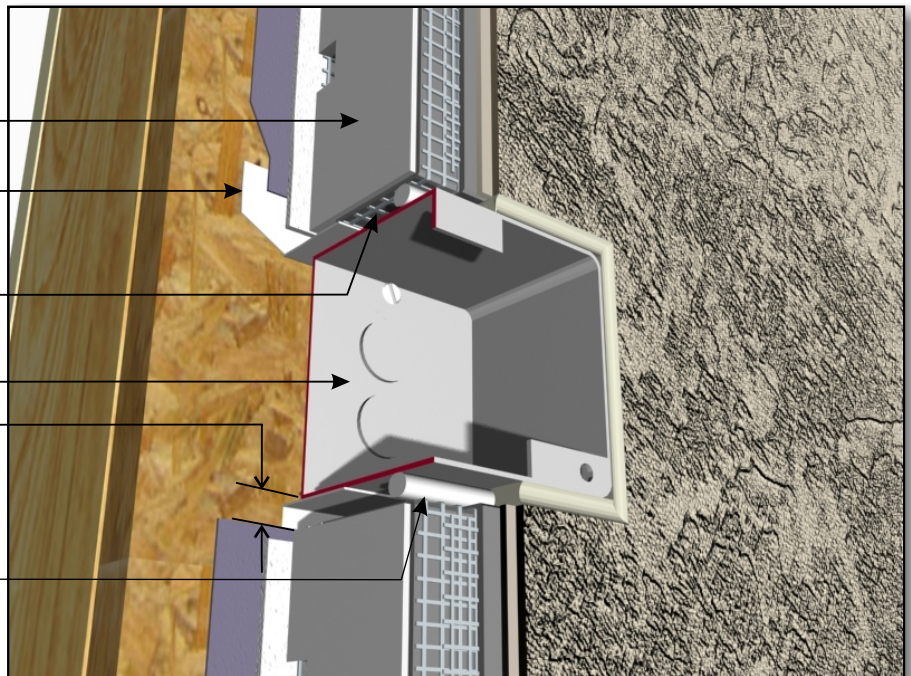

PUCCS-LRRC (11)
EXTERIOR ELECTRIC BOX PENETRATION