

101-B Roytec Rd. Woodbridge, ON, Canada, L4L 8A9

T: 905.856.0133 F: 905.856.9654 Toll Free: 1.888.238.6345 Email: info@durock.com

www.durock.com



JEWELSTONE PRODUCT GUIDE



MARION BARTLETT

Jewelstone opened up another dimension of creativity and allowed me to explore a new and versatile material, making my job much easier. In this project, the core steel provided the strength needed, while the Jewelstone covering the carved, high density polystyrene, gave a faux stone finish. The choices of colours and the technique of blending these into a myriad of hues and shades, gave a totally unique effect. The results are amazing and appear as aged, chiselled stone or marble sculptures. The people at DuROCK provided all the advice and support I needed to accomplish this challenging project.

COLOUR GUIDE

			
BLUSH	SANDLEWOOD	SABLE	TERRA COTTA
			
IRISH CREAM	CHAMOIS	ANTIQUÉ WHITE	CAMEL
			
IVORY	SAHARA BEIGE	ALMOND	CHOCOLATE BROWN
			
OLIVE GREEN	LIGHT SILVER	TEAL BLUE	CAFÉ LATTE
			
CONCRETE	PEARL GREY	AZTEC RED	WINE
			
SILVER GREY	SLATE GREY	BLACK	MOCHA

This colour guide is just a representation of our standard Jewelstone colours. Actual colours may vary.

STYLE CREATIVITY

Jewel Stone is the ultimate in acrylic modified cement-based coatings that transforms everyday concrete into beautiful decorative faux stone finishes. Jewel Stone can be used to restore and beautify old deteriorating concrete. It is ideal for walk ways, terraces, patios, pool areas, or any industrial or recreational flooring that requires the look and performance of stone. The luxurious and classic beauty of hand laid stone, slate, flag-stone, fieldstone, tile or wood plank in any combination of colours can be achieved with Jewel Stone at a very affordable price.



- Available in hundreds of colour combinations
- Endless creative possibilities
- Economical and easy to install
- Can be applied to most surfaces
- Can withstand heavy traffic
- Endures harsh freeze thaw cycles
- Excellent abrasion resistance

POOL DECKS



ARTFUL MODERN

Jewelstone blends polymer resins with cement, sand and other additives to improve performance, wear resistance and aesthetic qualities. It adheres well to existing concrete and resists damage from UV exposure, freeze-thaw conditions and abrasion. Jewelstone offers a great deal of value for rejuvenating worn or existing concrete.



JEWELSTONE PLUS OVER DuROCK EIFS

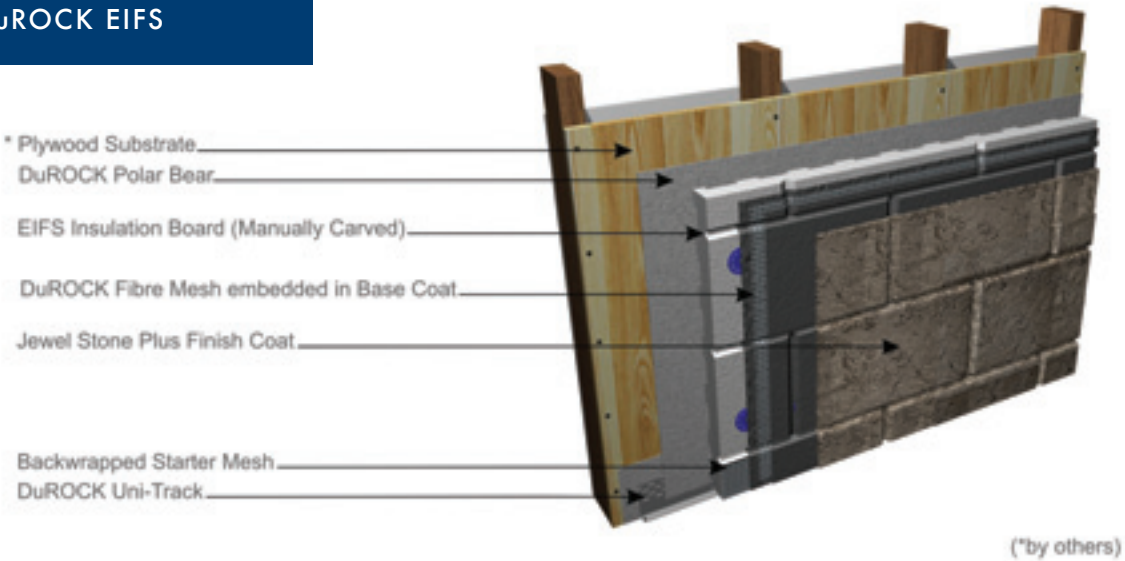

JEWELSTONE PLUS OVER PLYWOOD SUB-FLOOR

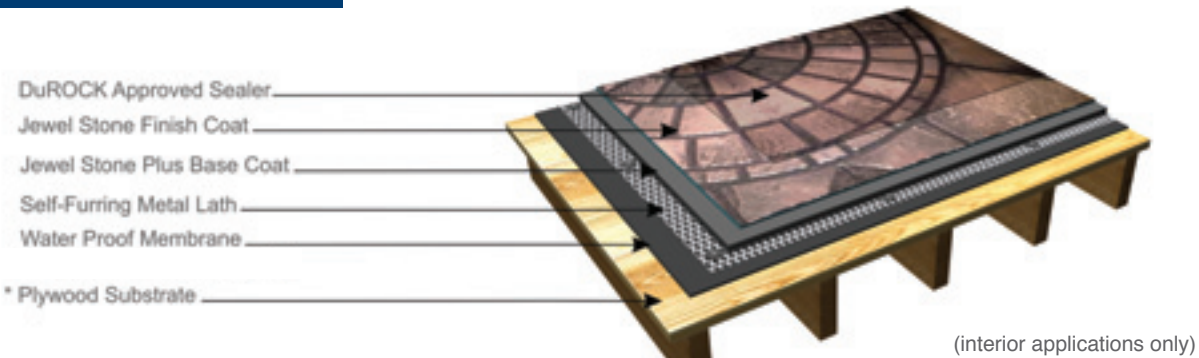

JEWELSTONE QUARTZ OVER EXISTING CERAMIC TILES

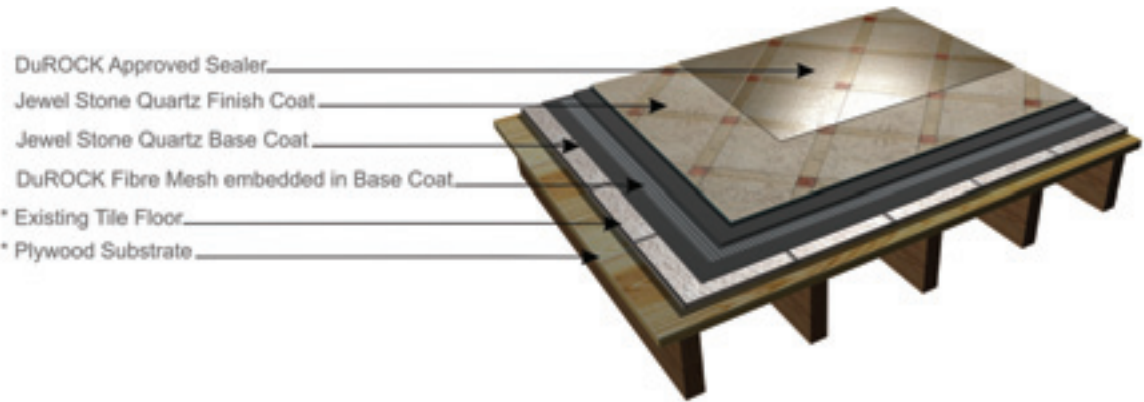

JEWELSTONE APPLICATIONS

FOR USE OVER ANY SURFACE

Jewelstone is a modified cement overlay system for horizontal and vertical applications. It can be applied over concrete, plywood, ceramic tiles or over DuROCK Exterior Insulated Finish Systems.

JEWELSTONE OVER CONCRETE BLOCK WALL

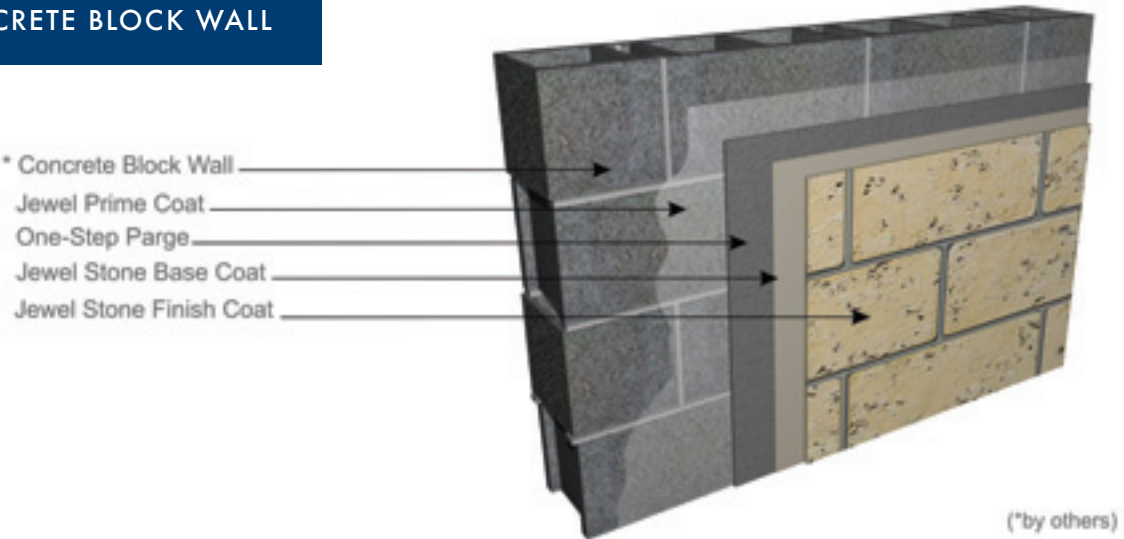

JEWELSTONE OVER CONCRETE FLOOR

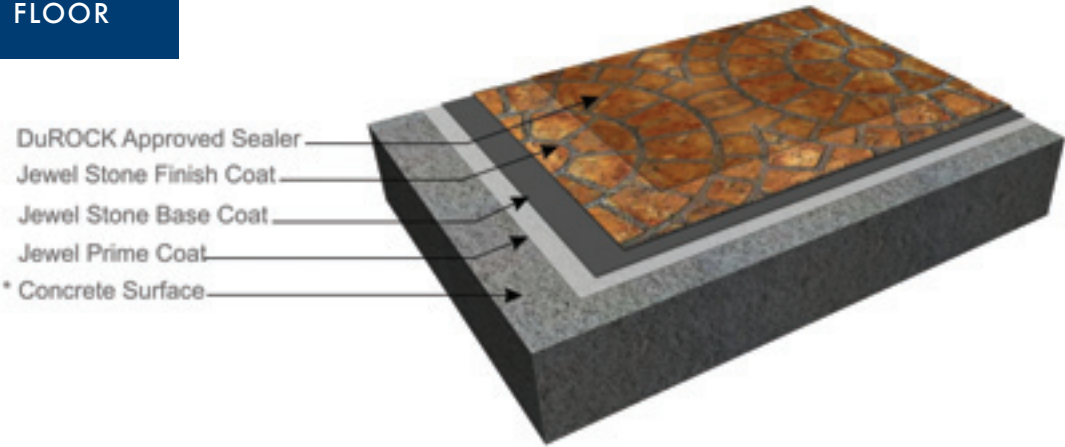



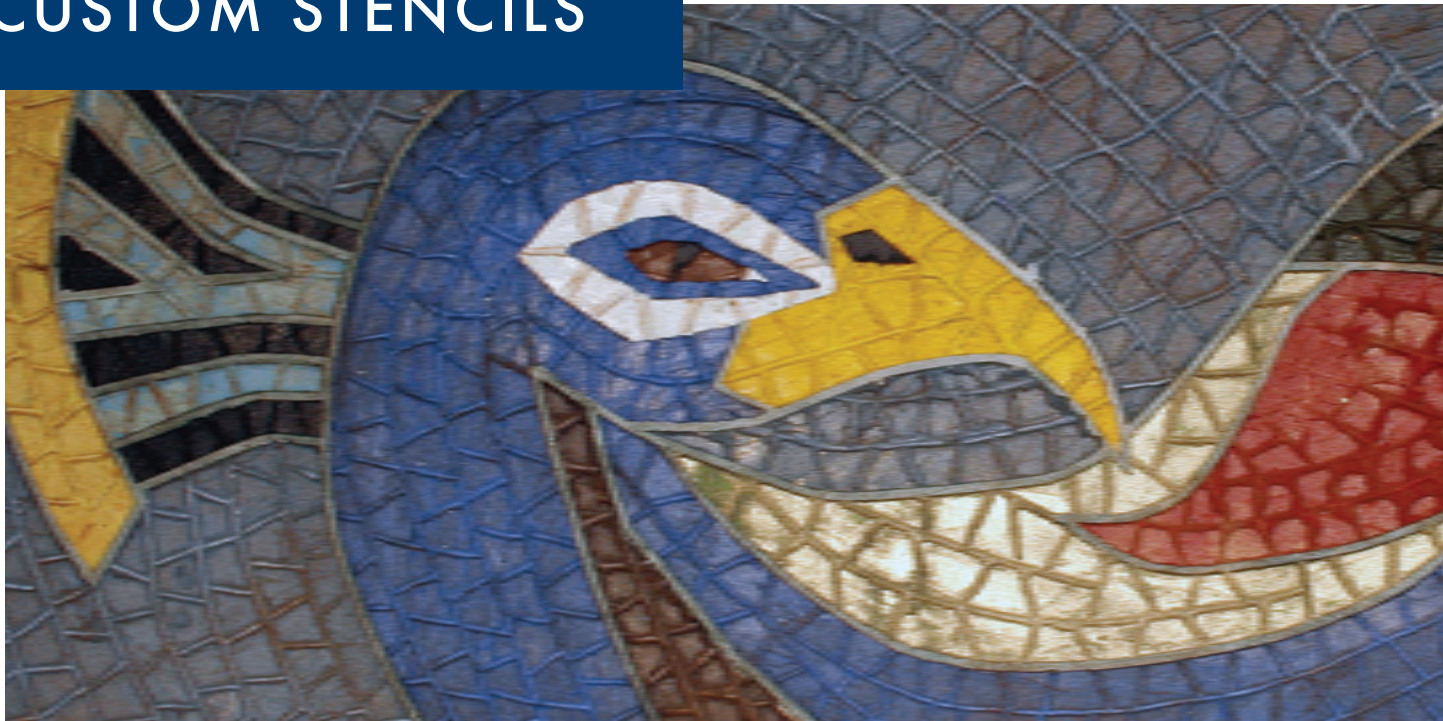

COMPLEX MADE EASY

Stencils offer unlimited options for taking concrete to the next level. Available in an array of custom patterns from borders to corners, medallions and motifs, stencils can be custom designed and cut to order for your specific project needs. More decorative concrete contractors are literally climbing the walls to demonstrate new vertical applications for their artistry. They are defying gravity with the use of our Jewelstone materials that can be applied directly over virtually any properly prepared wall surface, including concrete, masonry, wood, cement board, plaster, drywall and insulated concrete forms.



CONCRETE STAIRS



THE ART OF STONE

Jewelstone is the ideal choice for steps and patio areas as it can be customized to fit the style and architecture of any home or landscape. With the strength and ability to withstand the most extreme weather conditions, Jewelstone can be applied to any exterior concrete slab to beautify and add value to your home or property.









COMMERCIAL STRENGTH & DURABILITY.

The versatility of Jewelstone in commercial applications is unmatched by any other flooring material. An endless choice of colour and design capability allows you to create a look that is as unique as you are. Sealing the Jewelstone with Durathane or Epoxy will enhance the durability and performance in high traffic areas and allow for easy maintenance.



