

# DuROCK PUCCS EIFS

## Exterior Insulation Finish System for Low Rise Residential Construction

**DuROCK**  
 ARCHITECTURAL FINISHING SYSTEMS

- Wrap insulation edge with mesh-reinforced base coat
- DuROCK PUCCS EIFS
- \* Soffit
- DuROCK Finish Coat

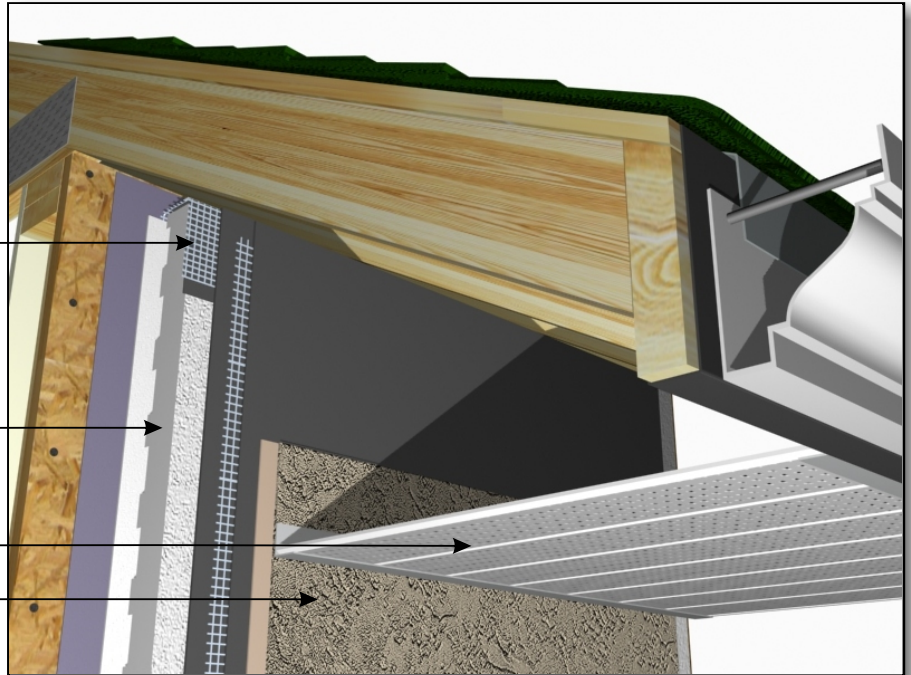

**PUCCS-LRRC (15)**  
TERMINATION AT SOFFIT

- DuROCK PUCCS, EPS Insulation Board
- Polar Bear applied around electric box and onto sheathing
- Wrap insulation edge with reinforcing mesh, terminate base coat at GDCC
- \* Weather tight electrical box
- Note: Provide approximate 15 mm space between electric box and insulation board
- \* Backer Rod and Sealant

(\* by others)

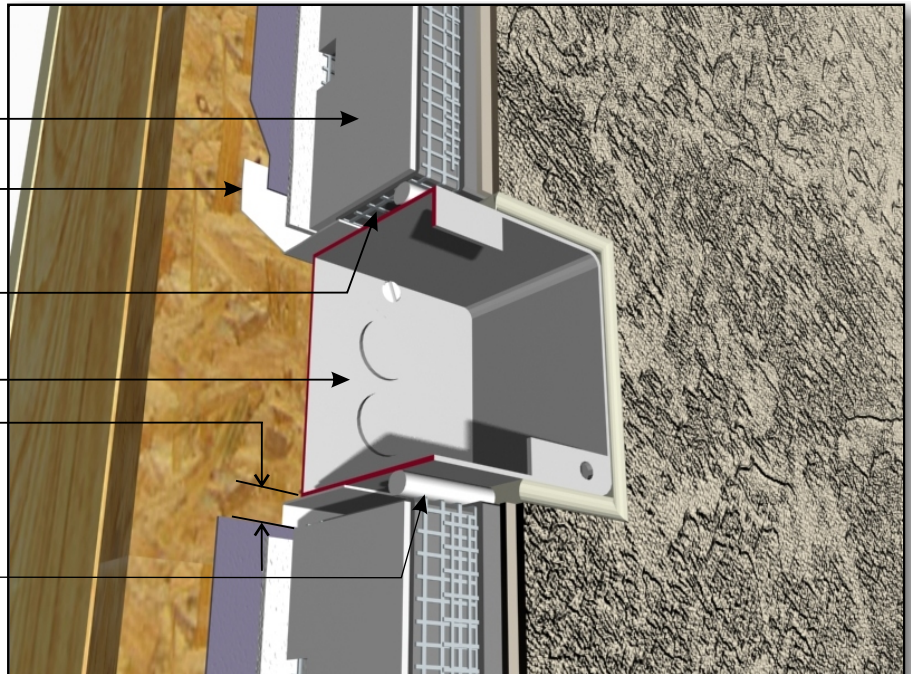

**PUCCS-LRRC (16)**  
EXTERIOR ELECTRIC BOX PENETRATION